

**MANUAL** English • Nederlands • Deutsch • Français

# AQUAFORTE AUTOMATIC FEEDER

---

## 6 LITER WITH SOLAR PANEL

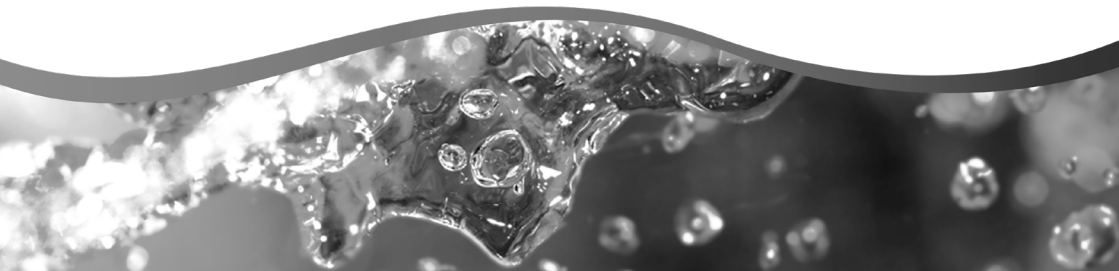

## **INTRODUCTION**

Congratulations on your purchase. In order to minimise the risk of injury, please always take some basic safety precautions when using this product. Please read this manual carefully and keep it for future reference.

The product is not intended for commercial use. Only use the device as intended. No liability will be accepted for any damage caused by failure to observe these operating instructions. For safety reasons, this appliance is not intended for use by children under 16 or by persons with reduced physical, sensory or mental capabilities, or with lack of experience and knowledge of how to use the product. Keep the instructions and pass them on to the new owner when the product is passed on.

## **FUNCTIONS**

- The unit is powered by solar energy. Once fully charged, the 2200 mA high capacity lithium battery provides three months of uninterrupted use without the need for additional sunlight or recharging.
- Equipped with a socket for adapters (the voltage of the adapter must be 12 V, the adapter must be purchased separately).
- When not in use for an extended period, the external switch should be turned off. This prevents the battery from leaking, as this would affect the life of the device.
- With a large, high-quality screen.
- The design of the newly added protective cover not only prevents false activation, but also effectively protects the sensitive control panel from environmental influences, thus extending the life of the unit.
- Has a capacity of 6 litres.
- Equipped with a transparent feed holder and feeder.
- The unit operates fully automatically and can be set for up to 6 feedings per day, each with a feeding time of up to 20 sec.
- The horizontal opening covers a 120° angle when distributing the feed, and the three different power levels ensure that the entire pond is supplied with fish food.
- The housing of the device is made of light and resilient acrylonitrile-butadiene-styrene (ABS)

## **SAFETY INSTRUCTIONS**

- The installation position must be firm to prevent it from falling into the water.
- You can hear the buzzer sound every time you press set button.
- When setting the mode, if there is no key input within 10 seconds, the system will automatically exit the setting mode and return to the real-time time display interface.

AquaForte is a trademark of Sibo Fluidra Netherlands BV, Doornhoek 3950, 5465TC, Veghel  
Email: [info@aqua-forte.nl](mailto:info@aqua-forte.nl) Website: [www.aqua-forte.nl](http://www.aqua-forte.nl)

# INSTALLATION

## Installation option 1:

Install the inserted bar and insert the whole part into the earth by pond.

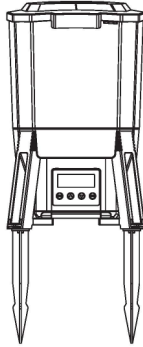

## Installation option 2:

Fix the feeding device on board or ground with screws.



# FUNCTION INDICATOR

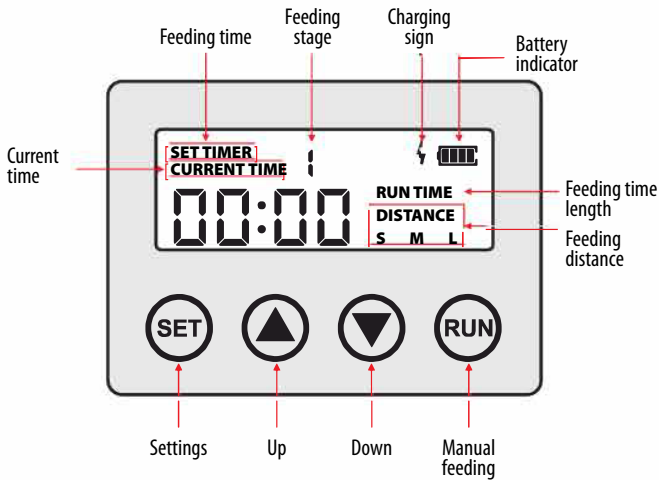

1. Current time: Short press can adjust the displayed current time.
2. Feeding time: Set the feeding start time.
3. Feed Frequency: sets the frequency of daily feedings with a maximum of 6 daily feedings.
4. Charge Indicator: flashes during charging and remains visible when the battery is fully charged.
5. Charge level indicator: shows the current charge level of the battery.
6. Feeding duration: sets the duration of each feeding (up to 20 s).

7. Feeding distance: controls the force with which the food is distributed.
  - S: Small-scale feeding  
Uses about 60 % motor power and has a spreading radius of about 1 m.
  - M: Medium-scale feeding  
Uses approx. 80% motor power and has a spreading radius of approx. 2 m.
  - L: Large-scale feeding  
Uses approx. 100% motor power and has a spreading radius of approx. 3 m.
8. Manual feeding: Long press for 3 seconds and it will start feeding for 3 seconds.
9. Down button: Used to decrease the time and other values.
10. Up button: Used to increase the time and other values.
11. Settings: press this button to switch between modes briefly.

## SETTINGS

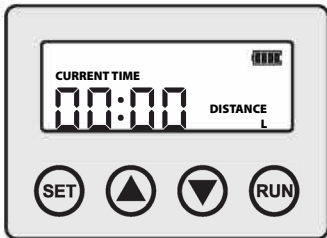

PIC 1

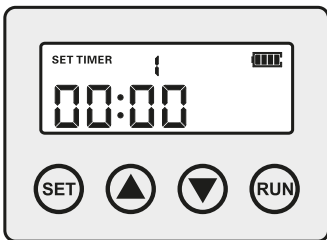

PIC 2

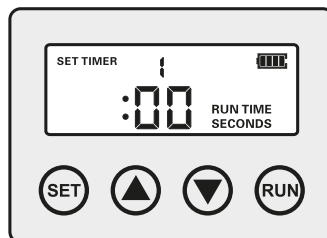

PIC 3

1. Turn on the external power switch. By default, the screen will be displayed as in pic 1. Press the SET button briefly to enter the current time and enter the hour setting. Short press the SET button again to enter the minute setting. Use the "Up" and "Down" buttons to increase or decrease the respective units.
2. If you press the "SET" button again the letter "L" will flash on the display (see pic. 2) and the system will move to the feeding distance settings. With the "up" and "down" buttons you can switch between the 3 different distribution settings. For more details, see the information on the control panel (see above).
3. To set the feeding stage, briefly press the "SET" button until the display matches pic. 2. The level can be changed. The level can be changed up to 6 time stages per day. Set the level and time for each feeding using the "Up" and "Down" buttons.
4. When you enter the settings for the feeding time, "RUN TIME" appears in the display (see pic. 3). The duration of the individual feedings can be set using the 'Up' and 'Down' buttons. The duration of the feeding can be set from 0 to 20 s, where 0 s means that no feeding takes place.

## TECHNICAL DATA

Model	CFF-206
Fish food grain size (mm)	3 - 10
Distribution angle (°)	120 (horizontal)
Capacity (ℓ)	6
Feeding times per day (number)	1 - 6
Lithium battery capacity (mA)	2200
Adapter Specification	12 V, 1,66 A
Dimensions (mm)	275 × 252 × 420

## TROUBLESHOOTING

Problem	Possible cause	Solution
No display.	Loosen internal connection cable.	Unscrew the bottom screws and refix them.
	Battery has no power.	Place in sunlight for solar charging.
		Charging with 12V Adapter (adapter needs to be purchased separately).
The display works but there is no response.	The impeller is stuck.	Clean the foreign matter in the impeller.
The impeller is rotating but no feed is thrown out.	Feed lumps.	Remove lumps.

# PARTS LIST

CFF-206

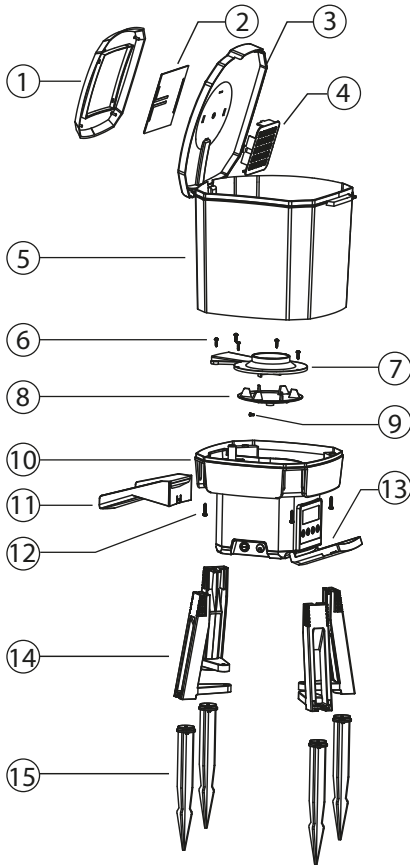

1	Transparent lid
2	Solar panel
3	Bucket lid
4	Desiccant carrier
5	Feed bucket
6	Screw 1
7	Impeller cover
8	Range
9	Screw 2
10	Main body
11	Feeder
12	Screw 3
13	Protective cover
14	Standaard
15	Ground anchor

## DISPOSAL REGULATIONS

The EU Directive on Disposal of Waste Electrical and Electronic Equipment (WEEE, 2012/19/EU) was implemented by the Electrical and Electronic Equipment Act. Disposal of used electrical and electronic equipment (to be used in the countries of the European Union and other European countries with a separate collection system for this equipment). The symbol on the product or on its packaging indicates that this product must not be treated as normal household waste, but must be taken to a collection point for the recycling of electrical and electronic equipment. By contributing to the proper disposal of this product, you are protecting the environment and the health of your fellow human beings. The environment and health are endangered by improper disposal. Material recycling helps reduce the consumption of raw materials. For more information on how to recycle this product, contact your municipality, your local waste disposal facility or the store where you purchased the product.

